



KIA Genuine Approved Accessories

Vehicle Model Forte Koup
 Model Year 2010
 KMA Part No. 1M034ADUP1

Accessory Rear Wing Spoiler
 Difficulty (B) - (C)

- Accessory Installation

Note: Difficulty stated above reflects the minimum level of expertise required to install the accessory
 (A) Customer (B) Dealer Technician (C) Master Technician

Instructional Symbols / Definitions

	Denotes warnings that may lead to serious physical injury or vehicle damage.		Denotes quality processes to be checked prior to moving to the next step.		Denotes safety equipment required to be used such as a mask, goggles, rubber gloves, and hearing protection.
	Denotes cautions to be taken to avoid physical injury or electronic component damage.		Denotes specific tools that are necessary to complete the step.		Mask
	Denotes cautions to be taken to avoid vehicle and component damage.		Denotes instructional steps necessary to complete the process.		Goggles
					Ear Protection
					Rubber Gloves

Basic Required Tools

Goggles	Masking Tape	Power Drill	Rubber Gloves
Drill-bit 1/8 (3.0MM)	Step Drill 5/16" (8.0MM) 3/8" (9.5MM)	Deburring Tool	Air Gun
50/50 IPA/Water mix	Soft Cloth	Vacuum	1/4" Drive Ratchet
Drop Cloth	Touch-up Paint	Primer	Plastic Rod

Specialty Tools Required

<p>The Trunk Lid Tool - P/N 09861 22000, may be ordered through Snap-on Business Solutions at (888) 542-1011</p>	
1/4" Drive Exten.	1/4" Drive Socket (10 mm)
1/4" Torque Wrench	Phillips Screw Driver
Wire Hook	Wire Snake

Notes to Installer

Read the entire installation pamphlet prior to beginning the installation of the accessory.
 Ensure that the vehicle is properly protected in the area that the accessory is to be installed.
 To prevent vehicle damage, never place tools on top of painted surfaces, seats, dash pad, console or floor carpet / mat.
 Always wear appropriate safety gear to include gloves and eye protection when required.

Kia Genuine Approved Accessories

Kit Overview

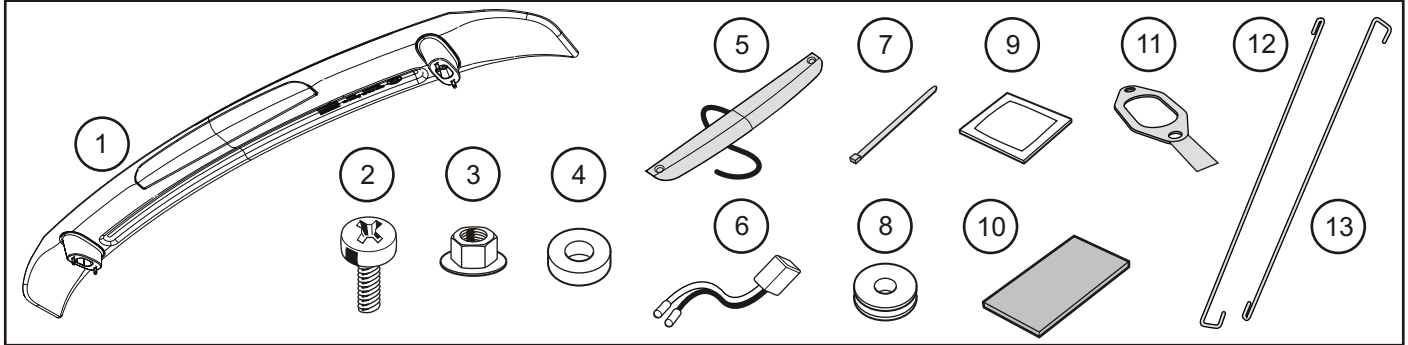

No.	Qty.	Description	No.	Qty.	Description	No.	Qty.	Description
1	1	Rear Wing Spoiler	6	1	Y-Connector	11	2	Adhesive Die-cut
2	2	M5 Screw	7	1	Cable Tie	12	1	LH (White) Torsion Bar
3	4	M6 Nuts	8	1	Rubber Grommet	13	1	RH (Yellow) Torsion Bar
4	1	Mastic (pasty) Washer	9	1	Alcohol Wipes	14		
5	1	CHMSL	10	3	Foam Pads	15		

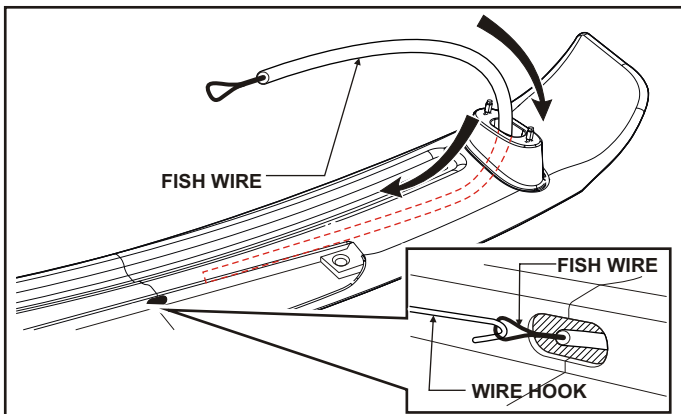

	Fish Wire	1
NOTE	A: Insert Fish Wire into access hole in the LH Spoiler Foot.	
	B: Feed Fish Wire towards the center of the spoiler. Use the Wire hook to pull out the Fish Wire through the wire access hole in the CHMSL area.	

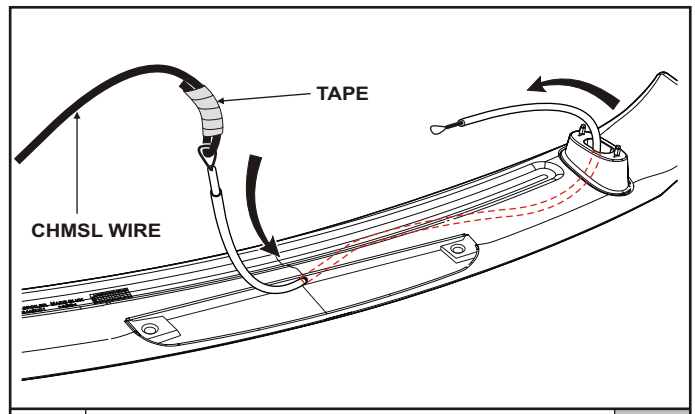

	Fish Wire, Masking Tape	2
NOTE	A: Attach CHMSL's wiring harness to the end of Fish Wire that was just pulled through the spoiler. Run the wire around the loop of the Fish Wire and secure with tape.	
	B: Pull the Fish Wire and CHMSL wire back through the Spoiler and out the LH Spoiler Foot.	

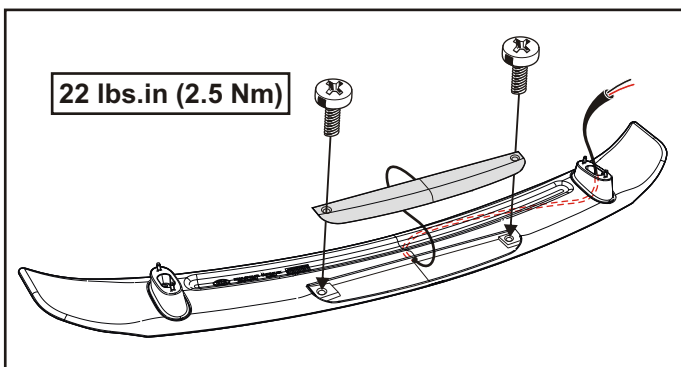

	Phillips Screw Driver, Torque Wrench	3
NOTE	A: Install the CHMSL on to Wing spoiler using a screw driver and the provided 2x M5 screws. Torque to 22 lbs.in (2.5 Nm) .	

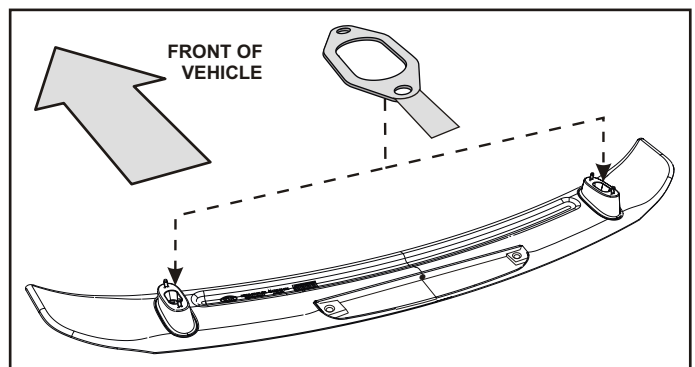

	IPA/Water Mix, Soft Cloth	4
NOTE	A: Clean LH and RH spoiler feet with IPA/water mixture and allow to dry.	
	B: Install an adhesive die-cut onto the RH and LH spoiler feet.	

Kia Genuine Approved Accessories

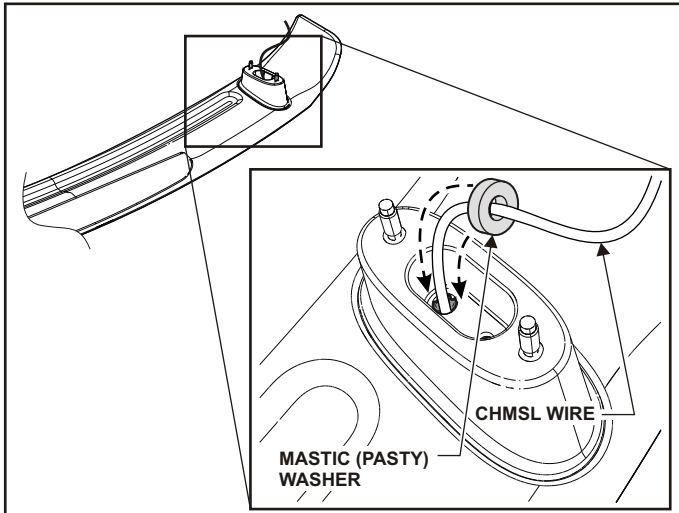

5

NOTE

- A: Insert mastic (pasty) washer into hole in Wing Spoiler Foot where the CHMSL Wire comes out.
- B: Ensure mastic (pasty) washer is compressed around hole.



Ensure that the mastic washer completely seals the hole.

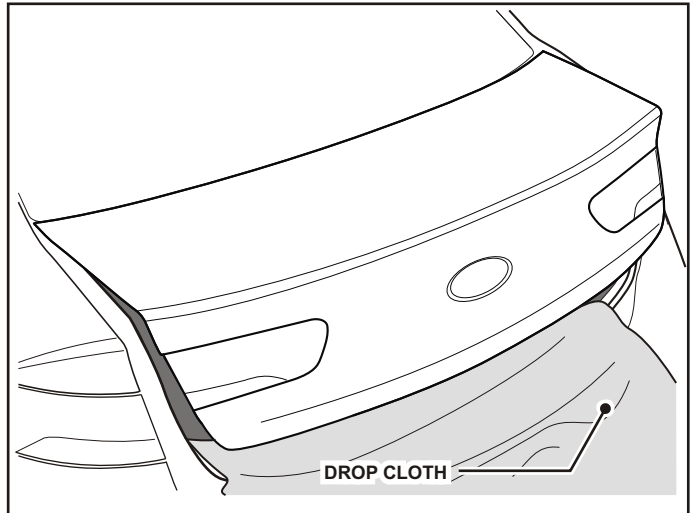

6



Drop Cloth

NOTE

- A: Place drop cloth inside trunk underneath the trunk lid.
- B: Prop open trunk lid approximately 1"

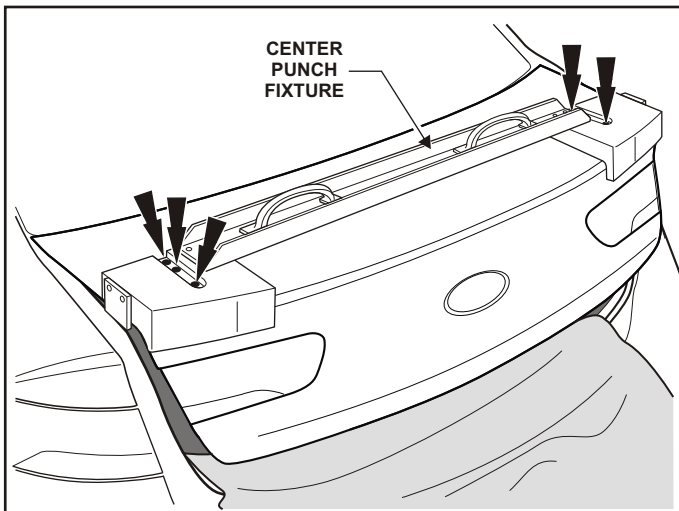

7



Spring Loaded Center Punch, Center Punch fixture

NOTE

- A: Place center punch fixture onto rear trunk lid. The fixture will locate using the curvature of the back edge of the trunk lid and the LH and RH edges.
- B: Using the spring loaded center punch, mark 5x hole locations. While using the center punch, hold the fixture against the trunk lid to ensure That it doesn't move out of alignment.



While center punching the 5x locations, ensure that center punch fixture is properly aligned and secured to the trunk lid.

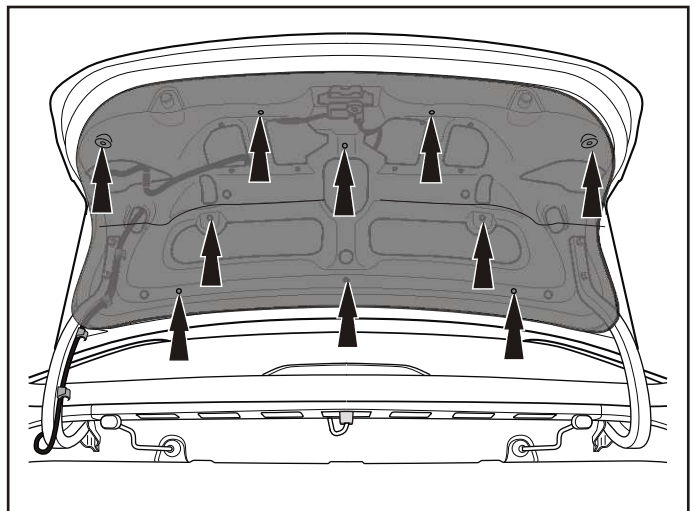

8



Phillips Screw driver

NOTE

- A: Remove the 10x fasteners from inner trunk lid trim using a Phillips screwdriver.
- B: Remove the inner trunk lid trim from the vehicle.
- C: Keep the fasteners for reinstallation.

Kia Genuine Approved Accessories

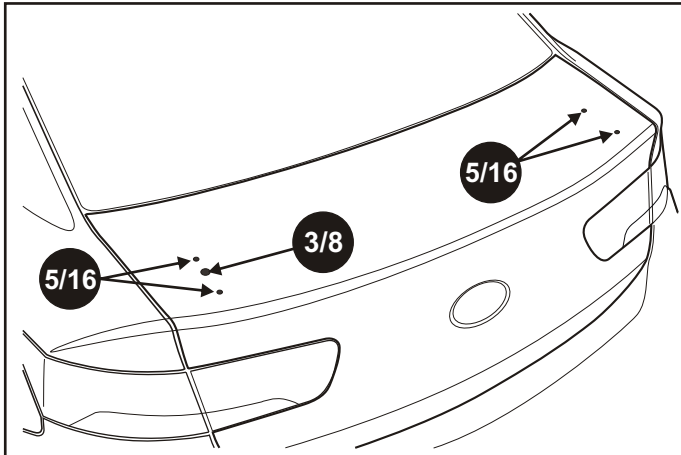

 Drill, 1/8"(3.0mm) Drill bit, Step Drill Bit, De-burring Tool, Air Gun 9

- NOTE**
- A: Remove template and drill a 1/8" (3mm) pilot hole at each of the 5x locations marked in step 6.
 - B: Use the step drill bit, enlarge (4X) mounting holes to the final size of 5/16" (8.0mm) and (1X) CHMSL Wire hole to 3/8" (9.5mm).
 - C: De-burr all holes.
 - D: Using the Air Gun, remove all metal shavings, caused by drilling, from the exterior surface of the trunk lid.
 - E: Using the Air Gun and vacuum, remove all metal shavings, cause by drilling, from the inside trunk lid panels.

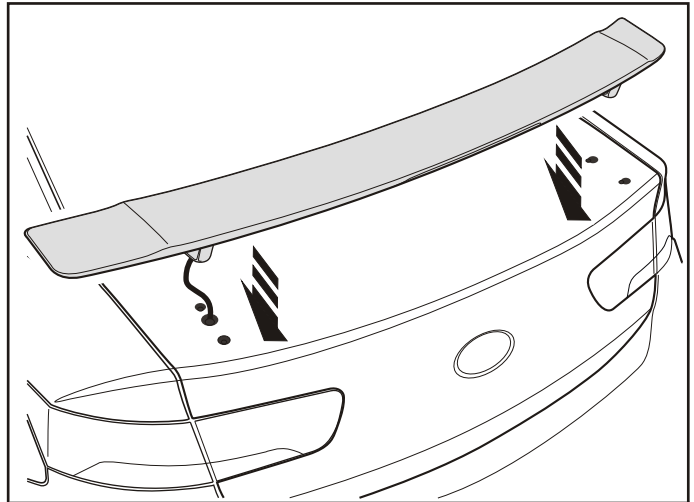

 10

- NOTE**
- A: Remove 4x rubber stud covers.
 - B: Test fit Spoiler onto trunk lid. Align studs on spoiler to holes drilled in trunk lid. Feed CHMSL Wire through the large 3/8" hole drilled in trunk lid.
 - C: Confirm cross-car alignment of spoiler on trunk lid. If required, adjust drilled holes for better fitment.
 - D: Remove spoiler from trunk lid.

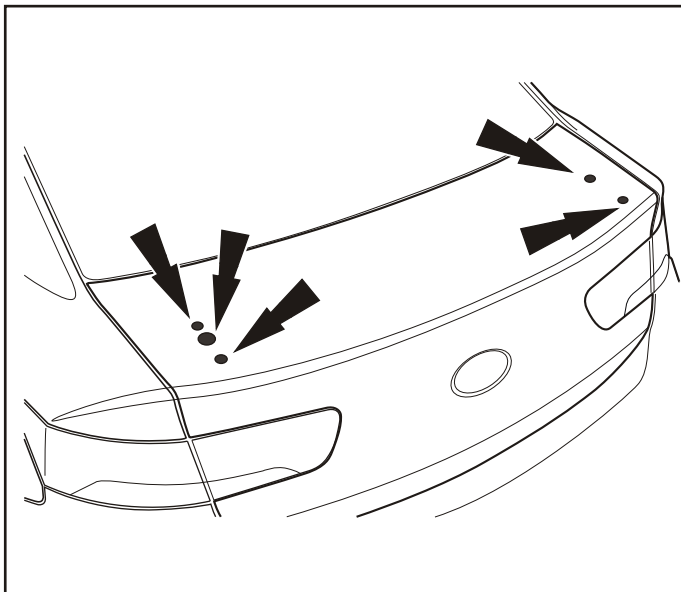

 Alcohol, Primer, and Touch-up Paint 11

- NOTE**
- A: Clean trunk lid surface with alcohol wipes.
 - B: Apply Kia approved Primer Paint to drilled holes.
 - C: Apply Kia approved Touch-up Paint to drilled holes.

 **Wait until Paint has dried before moving onto the next step.**

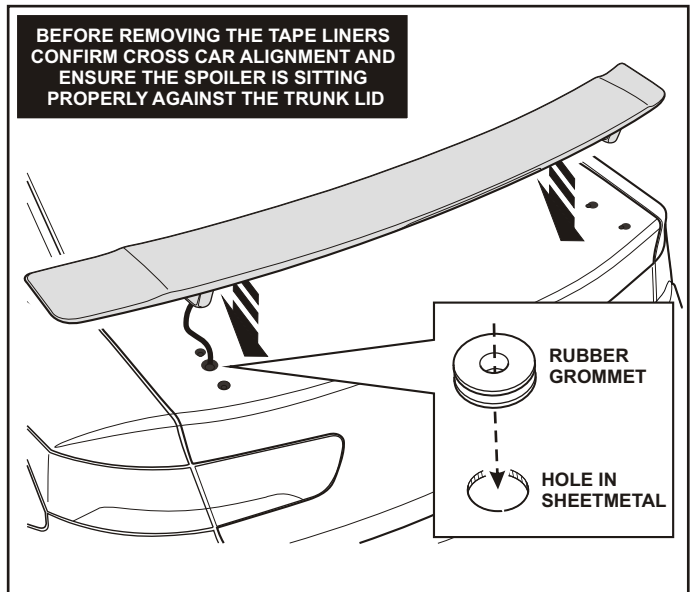

BEFORE REMOVING THE TAPE LINERS CONFIRM CROSS CAR ALIGNMENT AND ENSURE THE SPOILER IS SITTING PROPERLY AGAINST THE TRUNK LID

12

- NOTE**
- A: Install Rubber Grommet into 3/8" hole drilled in trunk lid.
 - B: Feed CHMSL Wire though Rubber Grommet and install Spoiler onto trunk lid. Align studs on spoiler to holes drilled in trunk lid. Ensure that Tape liner pull tabs are accessible.
 - C: Remove Die-cut tape liners from the LH and RH feet.
 - D: Before removing the tape liners, confirm cross car alignment and ensure the spoiler is sitting properly against the trunk lid.

Kia Genuine Approved Accessories

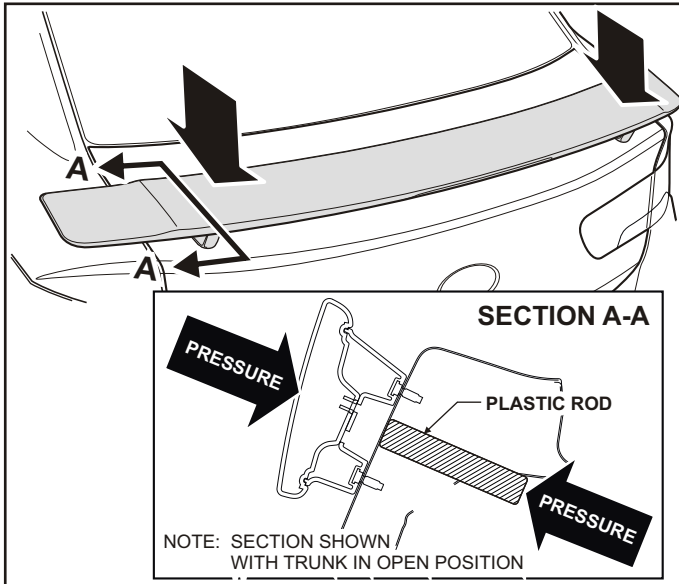

13

NOTE

- A: Apply pressure onto the spoiler over top of the mounting feet. This will ensure the spoiler will stay installed when you open the trunk lid in the next step.
- B: Open trunk lid. **Apply pressure to top surface spoiler over mounting foot while supporting the sheet metal from inside of the trunk lid with a Plastic Rod.** Repeat this step three times.



Make sure **Tape Adheres** to both the trunk lid and the spoiler.

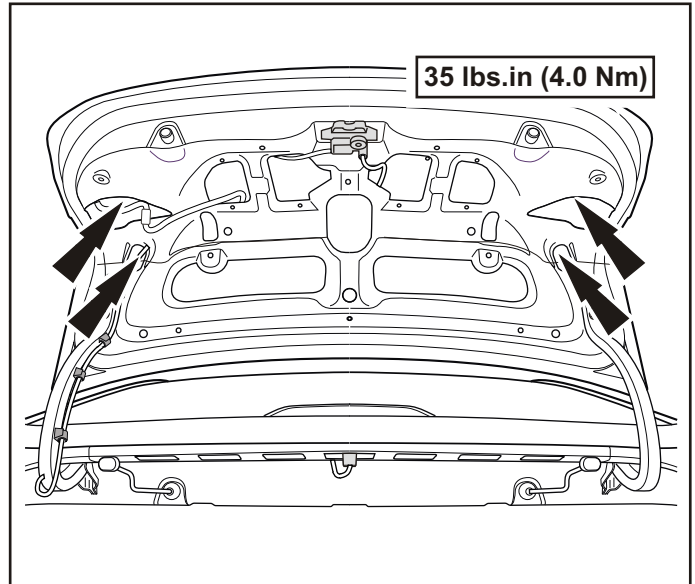

14



Ratchet, Socket (10mm), Extension, and Torque Wrench

NOTE

- A: With the trunk lid open, insert 4x M6 hex flange nuts onto spoiler studs as shown in the drawing above. Use the Socket (10mm), and Extension.
- B: Using torque wrench, tighten 4x M6 Hex flange nuts to **35 lbs.in (4.0 Nm)**.



Ensure not to drop the M6 hex flange nuts into the trunk lid during installation

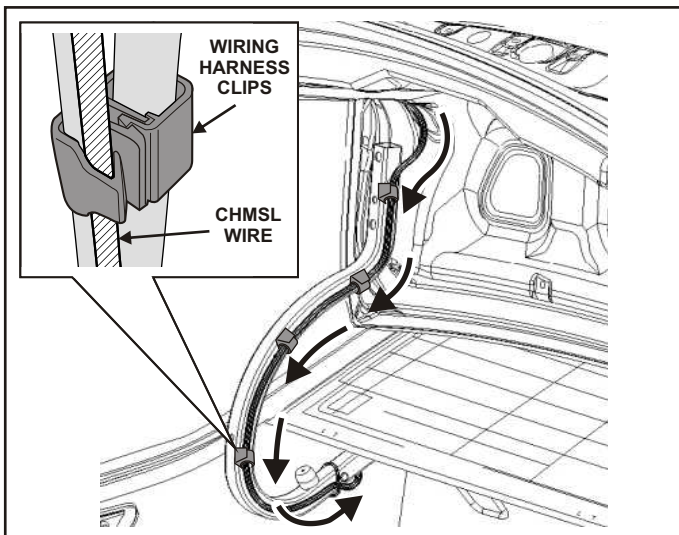

15

NOTE

- A: With the trunk lid open, run the CHMSL wire from the spoiler foot, along the existing vehicle wiring on the trunk lid hinge. Use the 4x existing Wire Harness clips to attached to trunk lid hinge.



Ensure that the Wire has been properly clipped-in.

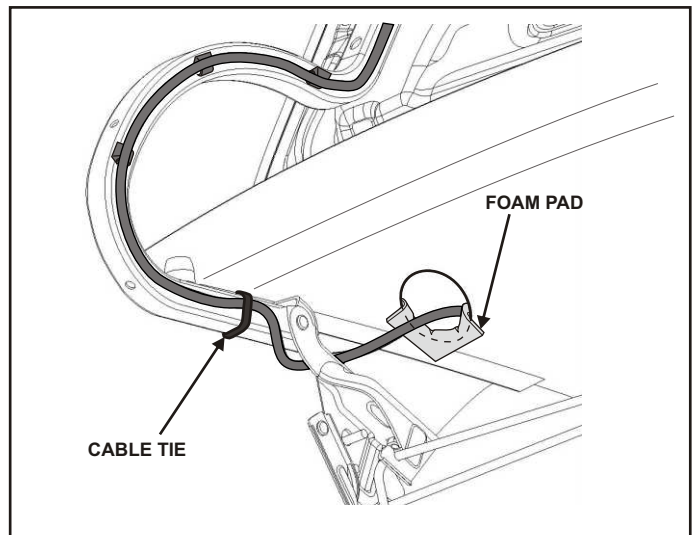

16

NOTE

- A: Run the CHMSL Wire through the hole in the sheet metal of the rear parcel tray. Secure CHMSL wire to trunk lid hinge using provide Cable Ties, as shown above.
- B: Stick one of the foam pads on the sheet metal edge where the CHMSL wire goes through.

Kia Genuine Approved Accessories

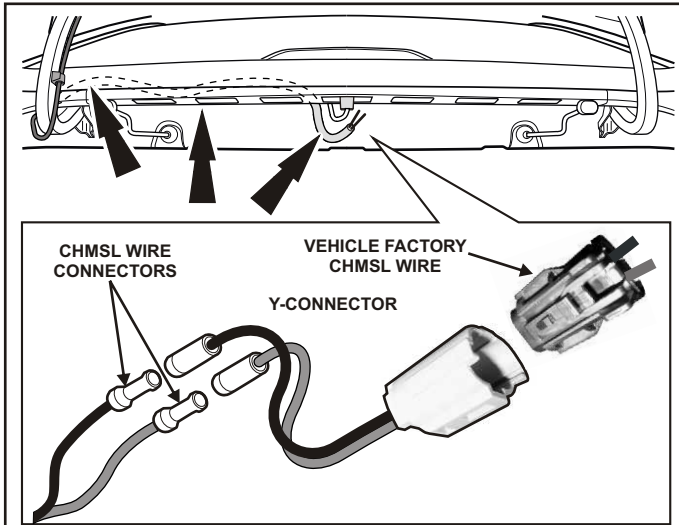

		17
NOTE	A: Disconnect the Vehicle's Factory CHMSL Wire and remove the bulb.	
	B: Connect the 'bullet' connectors of the CHMSL WIRE into the Female connectors on the Y-Connector. BLACK = BLACK and RED = GREEN. Cover these connectors with a Foam Pad.	
	C: Connect the Black plug on the other end of the Y-Connector into the Vehicles Factory CHMSL Wire.	
	D: Place the wire and connectors inside Parcel Tray sheet metal. Secure in place with a Foam Pad.	
	E: Re-install the inner trunk lid trim.	
	Confirm that the spoiler rear brake light is functioning.	

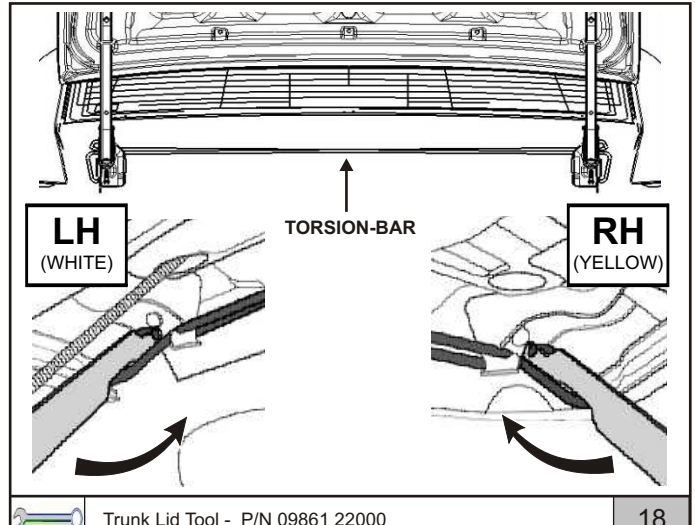

	Trunk Lid Tool - P/N 09861 22000	18
NOTE	A. Prop the trunk lid in the fully open position. This will prevent the trunk lid from falling closed during installation of the torsion bar.	
	B. Push down the left torsion bar by using the Trunk Lid Tool - P/N 09861 22000 and unhook the hinge from it.	
	C. Remove the left torsion bar by pulling it out from central clip.	
	D. Push down the right torsion bar by using the Trunk Lid Tool - P/N 09861 22000 and unhook the hinge from it.	
	E. Remove the right torsion bar by pulling it out from central clip.	
	F. Discard removed torsion bars	
	With the torsion bars removed, the trunk lid will not stay up. Therefore, you must use a prop to hold the trunk lid open during the installation.	

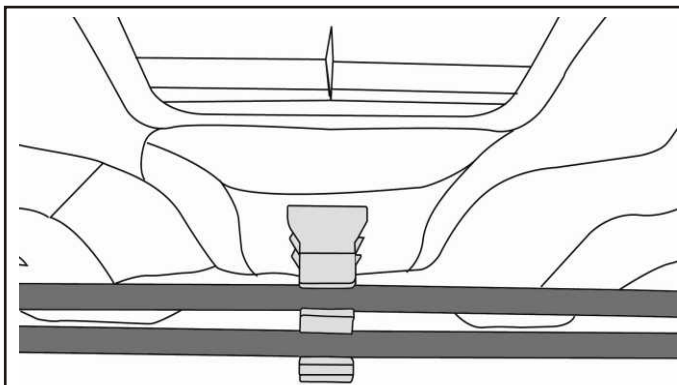

	Trunk Lid Tool - P/N 09861 22000	19
NOTE	A. Check the direction of provided torsion bar: Right(Yellow) and Left(White).	
	B. Install the provided left torsion bar by using the Trunk Lid Tool - P/N 09861 22000 and hook on to the left hinge.	
	C. Push the left torsion bar to the central clip.	
	D. Install the provided right torsion bar by using the Trunk Lid Tool - P/N 09861 22000 and hook on to the right hinge.	
	E. Push the right torsion bar to the central clip.	
	F. Check the trunk lid function properly.	
	With the torsion bars removed, the trunk lid will not stay up. Therefore, you must use a prop to hold the trunk lid open during the installation.	

RECOMMENDATIONS
<p>* Do not drive the vehicle at high speed (no more than 100km/h or 60mph) within 24 hours after installation!</p> <p>* Do not use machine car wash within 8 hours after installation!</p>